

Revisions		
Rev	Description	Date

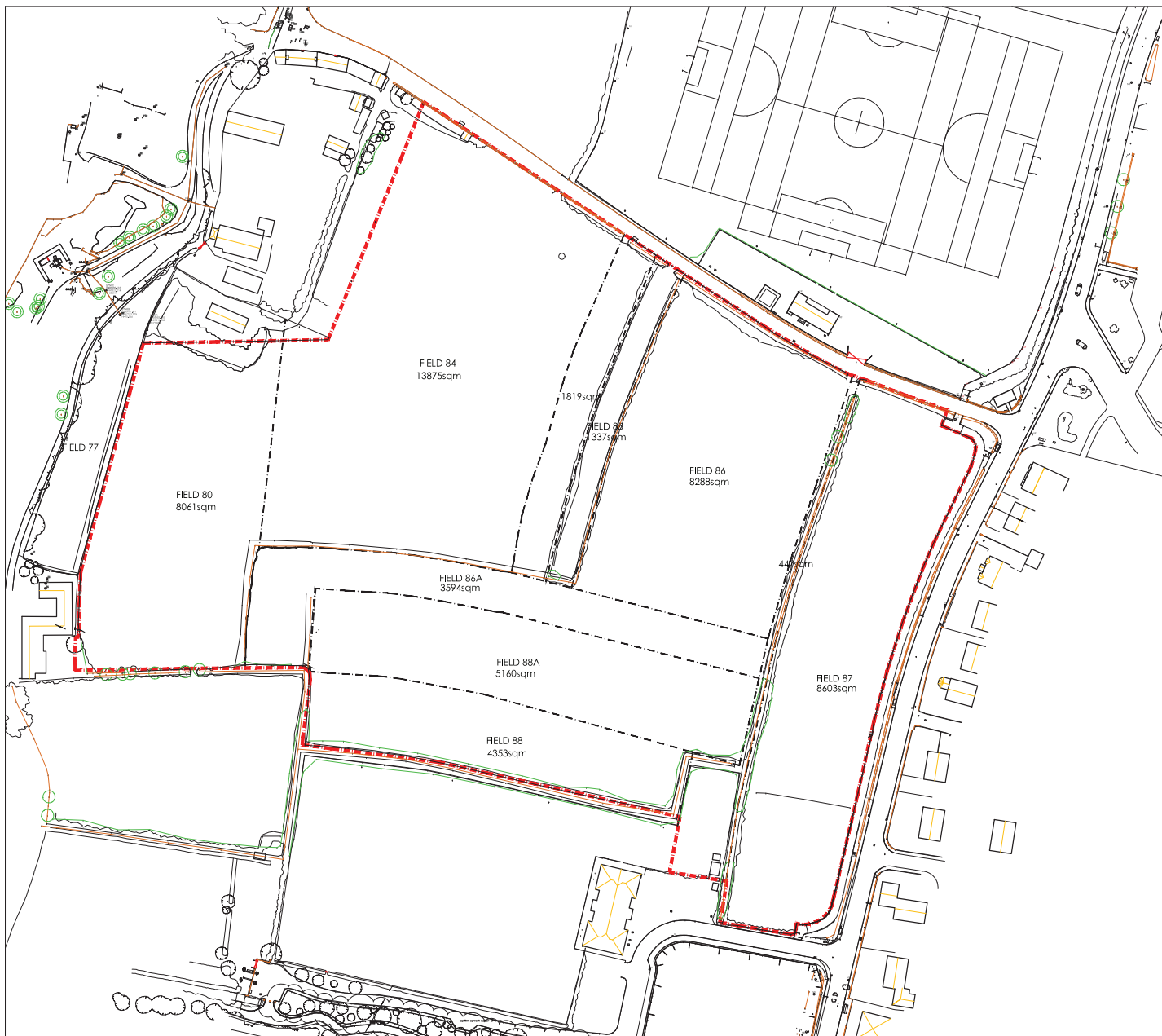

Boundary field positions indicated are not fixed and are for discussion purposes only to give approximate field areas.

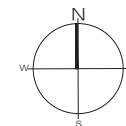

Do not scale from this drawing.  
This drawing may not be altered, traced, copied, photographed or used for any other purpose other than which it is issued without the permission of the Director of Infrastructure.  
The Contractor is to check all dimensions on site prior to commencement of any works and report any discrepancies to the Contractor.  
All details shown are based on site conditions related to the area. No responsibility can be accepted for ground conditions unless reported to the Contractor so that any amendments may be considered.  
Drawings should be read in conjunction with all other relevant and approved current drawings.

client

project  
**Les Quennevais  
 Secondary School -  
 Proposed New School**

drawing  
**Site Plan showing Legal  
 Site Boundary**

Treasury and Resources Department  
 Jersey Property Holdings  
 Design & Building Services  
 Maritime House,  
 La Route du Port Elizabeth,  
 St Helier, Jersey, JE2 3NW  
 Tel: +44 (0)1534 447800



scale 1:750@A1 date April 2017 drawn T Avis status S2

drawing no 10456-JPH-XX-XX-DR-A-SK20 revision

